

# 1 WiFi Stick Installation

**Alarm: The collector can only be plugged into the inverter, not any other device.**

**Step 1:**  
**For USB**  
 Rotate the lock, make sure the triangle mark is on the front and centered. Plug the Smart WiFi into WiFi/GPRS port under the bottom (underside) of the inverter. Tighten the nut clockwise as following.

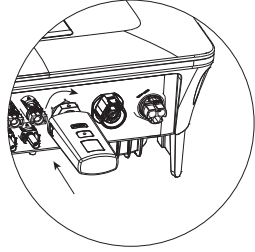

**For 4P Aviation plug**  
 Plug the Smart WiFi into WiFi/GPRS port under the bottom (underside) of the inverter. Make sure the label face to front. Tighten the nut clockwise as following.

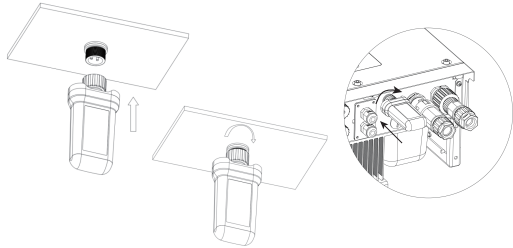

**Step 2:**  
 Power on the inverter (in accordance with the start-up procedure detailed in the inverter installation manual).

**Note:**  
 1. For Brasil: Regulamento Anatel sobre equipamentos de Radiocomunicação de Radiação Restrita (Resolução nº 680): "Este equipamento não tem direito à proteção contra interferência prejudicial e não pode causar interferência em sistemas devidamente autorizados".  
 2. Warning: This is a class A Product. In a domestic environment this product may cause radio interference in which case the user may be required to take adequate measures.  
 3. Products exported to Brasil have obtained ANATEL certification, and the following signs will be placed on the shell.



# 2 APP Installation

Scan the QR Code below to download and install the FoxCloud APP on your smartphone.

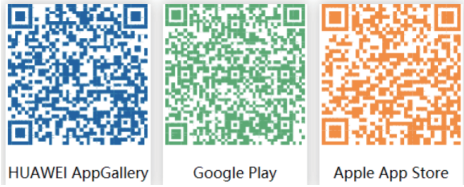

# 3 Configuration

Note: The module is powered on and started, please wait for one minute to start the WiFi Config.

**Web Configuration**  
**Step 1:**  
 Connect your mobile device with Smart WiFi. The SSID of the Smart WiFi is 'W-xxxxx' and the password is 'mtmt2020'.

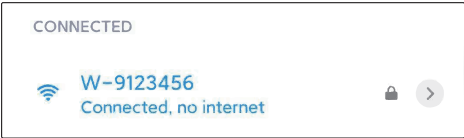

**Step 2:**  
 After connecting successfully. Open browser and enter '192.168.1.1' on the address bar on top.

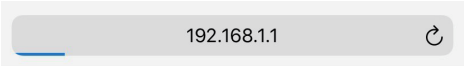

**Step 3:**  
 Drop down the WiFi SSID menu to find house router and input the house router's password. Click 'Save'.

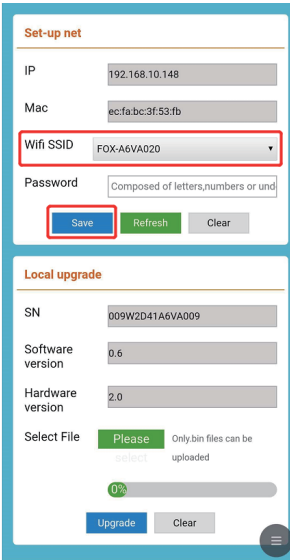

## APP Configuration

**Step 1:**  
 Open the APP, click "Local Distribution Network" on the login page.

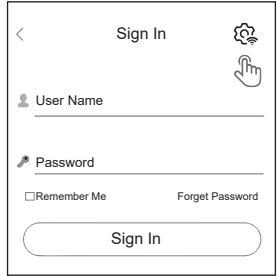

Then click "Wifi Config".



Or sign in app, click on the "me" page. Then click "WiFi Config".

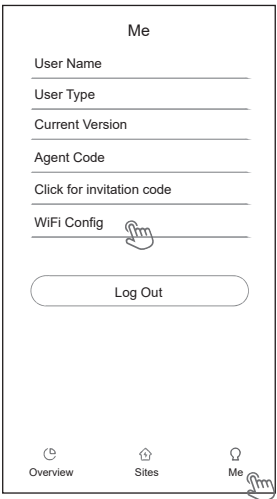

**Step 2:**  
 Please scan the "SN" on the collector.

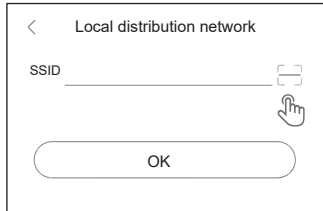

**Step 3:**  
 Connect your mobile device with Smart WiFi. The SSID of the Smart WiFi is 'W-xxxxx' and the password is 'mtmt2020'.

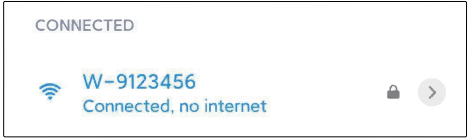

**Step 4:**  
 Please enter "Device WiFi" and "Password", then click 'OK'.

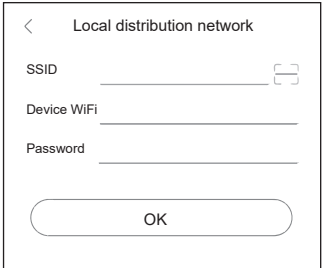

**Step 5:**  
 Distribution network is successful.

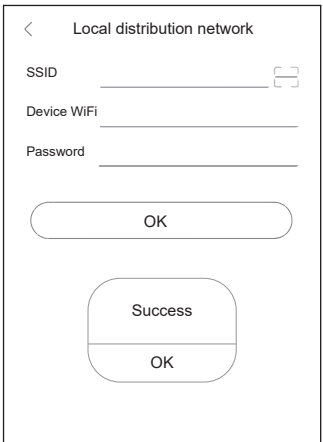

# 4 Register An Account

## For Installer

**Step 1:**  
 Please click 'Sign Up', enter installer's information to complete the installer account registration.

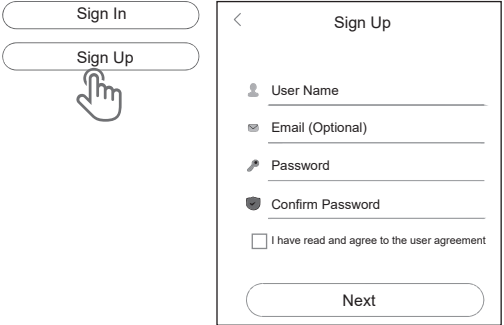

Note: If you already have an installer/agent account, please press 'Sign In' and enter with your installer/agent account directly.

**Step 2:**  
 Select 'Installer' and enter Installer name, then click 'OK'. We suggest you complete all information to ensure after-sales service.  
 Note:  
 Installer: The installer  
 Agent: The agent/distributor/installation company.

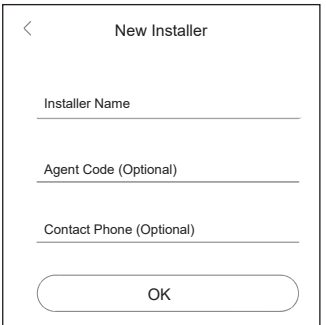
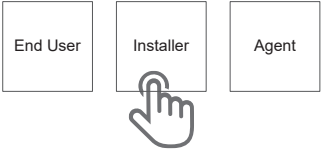

## For End User

**Step 1:**  
Please click 'Sign Up', enter end user's information to complete the end user account registration.

Sign In

Sign Up

Sign Up

User Name

Email (Optional)

Password

Confirm Password

I have read and agree to the user agreement

Next

**Step 2:**  
Select 'End User' then scan the WiFi bar code on the Smart WiFi, and click 'OK'. We suggest you complete all information to ensure after-sales service.

End User

Installer

Agent

End user

Datalogger SN

Agent / Installer Code (Optional)

OK



## 5 Create A Plant

### For Installer

**Step 1:**  
Open the APP, login with your Installer/agent account.

Sign In

User Name

Password

Remember Me [Forget Password](#)

Sign In

**Step 2:**  
Press the '+' icon on the homepage to add plant. Press the scan icon next to the 'Datalogger List' to scan the QR code label on front side of the Smart WiFi.

Sites

All Normal Alarm Offline

New Site OK

\*Site Name

\*Site Type

\*Country/Region

\*City

\*Address

\*Feed-in Tariff USD (\$) ▼

\*System Size kWp

\*PV Size kWp

\*Post Code

\*Agent DemoPlant

\*Time Zone

Seasonal

\*Datalogger List +

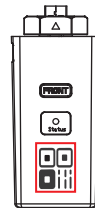

Note: After starting the APP, it will pop-up a message 'Whether to allow positioning permissions', please select 'Allow'. For the PV Size, please fill in the actual capacity of the installed solar panels.

## For End User

**Step 1:**  
Open the APP, login with your end user account.

Sign In

User Name

Password

Remember Me [Forget Password](#)

Sign In

**Step 2:**  
Press the '+' icon on the homepage to add plant. Press the scan icon next to the 'Datalogger List' to scan the QR code label on front side of the Smart WiFi.

Sites

All Normal Alarm Offline

\*Datalogger List +



Note: After starting the APP, it will pop-up a message 'Whether to allow positioning permissions', please select 'Allow'. For the PV Size, please fill in the actual capacity of the installed solar panels.

Note: If SN has been bound to the plant already, APP will go to the page as shown below. If SN has not been bound before, please refer to step 3.

Sites +

All Normal Alarm Offline

Overview Sites Me

**Step 3:**  
After scanning code successfully, click 'OK' on the top right corner of the page, APP will pop-up a message 'Add Datalogger', please click 'OK'. Complete all required information and click 'OK' on the top right corner of the page.

New Site OK

Add Datalogger

The datalogger is not associated with a site. Do you want to create a new site?

Cancel OK

New Site OK

\*Site Name

\*Site Type

\*Country/Region

\*City

\*Address

\*Feed-in Tariff USD (\$) ▼

\*System Size kWp

\*PV Size kWp

\*Post Code

\*Agent DemoPlant

\*Time Zone

Seasonal

\*Datalogger List +

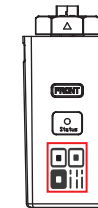

The manual is updated frequently. Please scan the code to download the latest version.



E-mail: [service@fox-ess.com](mailto:service@fox-ess.com)  
Website: [www.foxesscloud.com](http://www.foxesscloud.com)